

01.01.2022

Price list / Listino prezzi

Rebar connections HBT  
Standard program  
Armature di ripresa HBT  
Programma standard

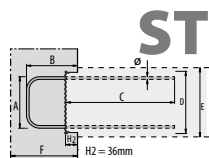

Model Modello	Steel Acciaio  Ø MM	Spacing Divisione CM  T	Length in CM Lunghezza in CM						Weight ML Peso ML		Price mt Prezzo / mt	
			A	B	C	D	E	F	Sheet and Reinforcement Lamiera e armatura	Reinforcement Armatura	1.25	0.85
80-8-15	8	15	6	12	40	8.6	12	15	3.60	2.78	58.40	63.40
80-8-20	8	20	6	12	40	8.6	12	15	2.91	2.09	54.50	59.95
S120-8-15	8	15	9	12	40	12.2	15	15	4.23	2.86	59.35	64.70
S120-8-20	8	20	9	12	40	12.2	15	15	3.51	2.14	62.15	66.35
S120-10-15	10	15	9	12	50	12.2	15	15	6.62	5.25	71.40	69.00
S120-10-20	10	20	9	12	50	12.2	15	15	5.31	3.94	70.70	69.10
120-8-15	8	15	9	15	40	12.2	15	20	4.38	3.01	60.25	66.90
120-8-20	8	20	9	15	40	12.2	15	20	3.62	2.26	58.30	64.25
120-10-15	10	15	9	15	50	12.2	15	20	6.86	5.49	73.60	73.10
120-10-20	10	20	9	15	50	12.2	15	20	5.15	4.12	78.95	77.25
120-12-15X	12	15	9	15	40	12.2	15	20	9.27	7.90	117.85	112.05
120-12-15Y	12	15	9	20	40	12.2	15	25	9.84	8.47	119.80	133.25
120-12-15Z	12	15	9	25	40	12.2	15	30	10.40	9.04	122.30	136.75
S150-8-15	8	15	12	8	40	15	18-20	11	4.29	2.73	70.55	74.65
150-8-15	8	15	12	15	40	15	18-20	20	4.65	3.08	62.35	67.50
150-8-20	8	20	12	15	40	15	18-20	20	3.87	2.31	63.95	70.55
S150-10-15	10	15	12	12	50	15	18-20	15	6.93	5.37	78.40	79.20
150-10-15	10	15	12	15	50	15	18-20	20	7.17	5.61	75.10	75.90
150-10-15Y	10	15	12	20	50	15	18-20	25	7.56	6.00	90.35	100.70
150-10-15Z	10	15	12	25	50	15	18-20	30	7.96	6.40	93.20	104.20
150-10-20	10	20	12	15	50	15	18-20	20	5.77	4.21	70.30	70.50
150-12-15X	12	15	12	15	60	15	18-20	20	10.77	9.21	102.60	93.80
150-12-15Y	12	15	12	20	60	15	18-20	25	11.34	9.78	115.45	128.95
150-12-15Z	12	15	12	25	60	15	18-20	30	11.90	10.34	121.00	135.60
150-14-15X	14	15	12	15	48	15	18-20	20	12.25	10.69	216.20	234.70
150-14-15Y	14	15	12	20	48	15	18-20	25	13.02	11.46	231.45	251.00
150-14-15Z	14	15	12	25	48	15	18-20	30	13.80	12.24	237.50	258.85

This price list does not include the current price increases.  
The short 0.85 mt elements are delivered with a dimension C of 40 cm.

Il presente listino prezzi non tiene conto del supplemento di prezzo.  
Gli elementi da 0,85 mt sono forniti con una dimensione C di 40 cm.

01.01.2022

Price list / Listino prezzi

Rebar connections HBT  
Standard program  
Armature di ripresa HBT  
Programma standard

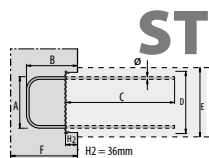

Model Modello	Steel Acciaio Ø MM	Spacing Divisione CM	Length in CM Lunghezza in CM						Weight ML Peso ML		Price mt Prezzo / mt	
			A	B	C	D	E	F	Sheet and Reinforcement Lamiera e armatura	Reinforcement Armatura	1.25	0.85
190-8-15	8	15	16	15	40	18.6	22	20	5.03	3.19	72.25	78.95
190-8-20	8	20	16	15	40	18.6	22	20	4.23	2.39	73.50	77.40
190-10-15	10	15	16	15	50	18.6	22	20	7.60	5.77	83.60	84.70
190-10-15Y	10	15	16	20	50	18.6	22	25	7.99	6.14	99.30	111.75
190-10-15Z	10	15	16	25	50	18.6	22	30	8.39	6.54	102.15	115.10
190-10-20	10	20	16	15	50	18.6	22	20	6.16	4.32	75.60	80.10
190-12-15X	12	15	16	15	60	18.6	22	20	11.26	9.43	110.30	108.50
190-12-15Y	12	15	16	20	60	18.6	22	25	11.83	10.00	123.30	137.55
190-12-15Z	12	15	16	25	60	18.6	22	30	12.39	10.57	130.05	145.20
190-14-15X	14	15	16	15	57	18.6	22	20	14.24	12.39	230.90	250.45
190-14-15Y	14	15	16	20	57	18.6	22	25	15.02	13.16	244.85	264.35
190-14-15Z	14	15	16	25	57	18.6	22	30	15.79	13.94	252.30	274.60
220-8-15	8	15	19	15	40	22.2	25	20	5.39	3.26	78.00	85.15
220-8-20	8	20	19	15	40	22.2	25	20	4.58	2.45	76.75	83.70
220-10-15	10	15	19	15	50	22.2	25	20	8.02	5.88	89.90	90.50
220-10-15Y	10	15	19	20	50	22.2	25	25	8.41	6.28	104.00	116.85
220-10-15Z	10	15	19	25	50	22.2	25	30	8.81	6.67	107.25	120.65
220-10-20	10	20	19	15	50	22.2	25	20	6.54	4.41	88.00	88.90
220-12-15X	12	15	19	15	60	22.2	25	20	11.74	9.60	113.30	114.70
220-12-15Y	12	15	19	20	60	22.2	25	25	12.30	10.17	126.65	141.60
220-12-15Z	12	15	19	25	60	22.2	25	30	12.87	10.74	131.15	146.95
220-14-15X	14	15	19	15	57	22.2	25	20	14.75	12.62	243.80	264.15
220-14-15Y	14	15	19	20	57	22.2	25	25	15.53	13.40	258.85	276.35
220-14-15Z	14	15	19	25	57	22.2	25	30	16.30	14.17	265.20	288.30

This price list does not include the current price increases.  
The short 0.85 mt elements are delivered with a dimension C of 40 cm.

Il presente listino prezzi non tiene conto del supplemento di prezzo.  
Gli elementi da 0,85 mt sono forniti con una dimensione C di 40 cm.

Price list / Listino prezzi

Rebar connections HBT  
Standard program  
Armature di ripresa HBT  
Programma standard

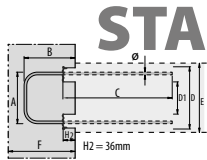

Model Modello	Boxes Piastre	Steel Acciaio	Spacing Divisione	Length in CM Lunghezza in CM								Weight ML Peso ML		Price mt Prezzo / mt			
				Ø MM	CM	T	A	B	C	D	D1	E	F	Sheet and Reinforcement Lamiera e armatura	Reinforcement Armatura	1.25	0.85
160-10-15	55	10	15	12	15	40	16	5	17	20	6.91	4.82	128.40	140.10			
180-10-15	55	10	15	14	15	40	18	7	19	20	6.99	4.90	133.60	148.70			
180-12-15X	85	12	15	14	15	60	18	1	19	20	11.40	9.32	139.20	156.10			
210-8-20	55	8	20	17	15	40	21	10	22	20	4.49	2.41	123.15	128.20			
210-10-15	55	10	15	17	15	40	21	10	22	20	7.10	5.01	116.30	126.20			
210-12-15X	85	12	15	17	15	60	21	4	22	20	11.58	9.50	123.10	135.80			
250-10-15	85	10	15	21	15	50	25	8	26	20	8.05	5.96	146.20	156.50			
250-12-15X	85	12	15	21	15	60	25	8	26	20	11.80	9.72	178.60	191.80			
250-12-15Y	85	12	15	21	20	60	25	8	26	25	12.42	10.29	201.85	217.20			
250-12-15Z	85	12	15	21	25	60	25	8	26	30	12.99	10.85	211.00	230.10			
250-14-15X	85	14	15	21	15	56	25	8	26	20	14.75	12.62	261.65	282.20			
250-14-15Y	85	14	15	21	20	56	25	8	26	25	15.53	13.40	285.10	307.50			
250-14-15Z	85	14	15	21	25	56	25	8	26	30	16.30	14.17	309.60	333.95			

This price list does not include the current price increases.  
The short 0.85 mt elements are delivered with a dimension C of 40 cm.

Il presente listino prezzi non tiene conto del supplemento di prezzo.  
Gli elementi da 0,85 mt sono forniti con una dimensione C di 40 cm.

Price list / Listino prezzi

Rebar connections HBT Standard program Armature di ripresa HBT Programma standard	Model Modello	Boxes Piastre	Steel Acciaio	Spacing Divisione	Length in CM Lunghezza in CM						Weight ML Peso ML		Price mt Prezzo / mt				
					Ø MM	CM	A	B	C	D	D1	E	F	Sheet and Reinforcement Lamiera e armatura	Reinforcement Armatura	1.25	0.85
280-8-15	55	8	15	24	15	40	28	17	30	20	5.47	3.39	93.25	104.80			
280-8-20	55	8	20	24	15	40	28	17	30	20	4.63	2.54	86.30	98.60			
280-10-15	85	10	15	24	15	50	28	11	30	20	8.17	6.08	106.40	108.00			
280-10-20	55	10	20	24	15	40	28	11	30	20	6.05	3.97	88.10	96.70			
280-10-15Y	85	10	15	24	20	50	28	11	30	25	8.56	6.48	119.90	133.10			
280-10-15Z	85	10	15	24	25	50	28	11	30	30	8.96	6.87	123.60	137.55			
280-12-15X	85	12	15	24	15	60	28	11	30	20	11.97	9.89	125.50	130.90			
280-12-15Y	85	12	15	24	20	60	28	11	30	25	12.54	10.46	141.05	156.40			
280-12-15Z	85	12	15	24	25	60	28	11	30	30	13.11	11.03	145.40	161.65			
280-14-15X	85	14	15	24	15	56	28	11	30	20	14.94	12.86	264.85	285.90			
280-14-15Y	85	14	15	24	20	56	28	11	30	25	15.71	13.63	277.45	301.30			
280-14-15Z	85	14	15	24	25	56	28	11	30	30	16.49	14.40	286.25	310.05			
280-14-15Z3	85	14	15	24	30	56	28	11	30	35	17.26	15.18	309.70	335.45			
280-14-15Z4	85	14	15	24	40	56	28	11	30	45	18.81	16.73	354.20	383.65			
380-14-15X	85	14	15	34	15	56	38	21	40	20	15.71	13.63	292.00	315.20			
380-14-15Y	85	14	15	34	20	56	38	21	40	25	16.49	14.40	324.90	350.65			
380-14-15Z	85	14	15	34	25	56	38	21	40	30	17.26	15.18	364.80	393.75			
380-14-15Z3	85	14	15	34	30	56	38	21	40	35	18.04	15.95	413.55	446.45			
380-14-15Z4	85	14	15	34	40	56	38	21	40	45	19.59	17.50	493.45	532.70			
480-14-15X	85	14	15	44	15	56	48	31	50	20	16.49	14.40	320.85	346.40			
480-14-15Y	85	14	15	44	20	56	48	31	50	25	17.26	15.18	355.95	384.35			
480-14-15Z	85	14	15	44	25	56	48	31	50	30	18.04	15.95	398.70	430.55			
480-14-15Z3	85	14	15	44	30	56	48	31	50	35	18.81	16.73	451.05	487.05			
480-14-15Z4	85	14	15	44	40	56	48	31	50	45	20.36	18.28	536.15	578.90			

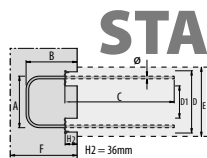

This price list does not include the current price increases.  
The short 0.85 mt elements are delivered with a dimension C of 40 cm.

Il presente listino prezzi non tiene conto del supplemento di prezzo.  
Gli elementi da 0,85 mt sono forniti con una dimensione C di 40 cm.

01.01.2022

Price list / Listino prezzi

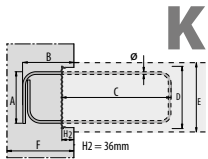
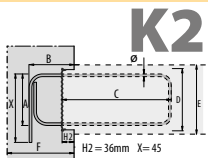
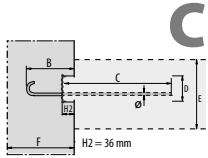
Rebar connections HBT Standard program Armature di ripresa HBT Programma standard	Model Modello	Steel Acciaio Ø MM	Spacing Divisione CM T	Length in CM Lunghezza in CM						Weight ML Peso ML		Price mt Prezzo / mt	
				A	B	C	D	E	F	Sheet and Reinforcement Lamiera e armatura	Reinforcement Armatura	1.25	0.85
 <p><b>K</b></p>	K120-10-20	10	20	9	15	18	12.2	15	20	4.12	2.75	63.90	67.70
	K150-10-15	10	15	12	15	13	15	18-20	20	5.19	3.63	81.50	90.30
	K150-10-20	10	20	12	15	18	15	18-20	20	4.58	3.02	72.40	76.80
	K150 10/15X	10	15	12	15	18	15	18-20	20	5.59	4.03	92.90	103.10
	K190-10-20	10	20	16	15	18	18.6	22	20	5.23	3.38	90.10	101.10
 <p><b>K2</b></p>	K2120-10-15X	10	15	9	15	18	15	18-20	20	6.90	5.54	166.75	187.60
	K2150-10-15	10	15	12	15	22	15	18-20	20	7.67	6.10	167.75	189.25
	K2150-10-15X	10	15	12	15	18	15	18-20	20	7.49	5.93	162.40	181.55
	K2150-10-20	10	20	12	15	18	15	18-20	20	5.56	4.00	105.60	115.10
	K2150-10-20X	10	20	12	15	18	15	18-20	20	6.57	5.01	141.00	153.90
	K2190-10-15Y	10	15	16	20	18	18.6	22	25	8.83	6.98	175.95	192.05
	K2190-10-15Z	10	15	16	22	22	18.6	22	25	8.94	7.09	183.40	200.55
	K2190-10-20	10	20	16	15	18	18.6	22	20	6.12	4.24	124.15	138.00
	K2190-10-20X	10	20	16	20	18	18.6	22	25	7.92	6.06	167.50	183.40
	K2190-10-20Y	10	20	16	20	18	18.6	22	25	6.41	4.53	124.25	137.25
	K2190-10-20Z	10	20	16	25	18	18.6	22	30	6.71	4.83	129.85	142.15
 <p><b>C</b></p>	55-8-15	8	15		15	40	5.5	VAR	20	2.46	1.59	48.60	55.85
	55-8-20	8	20		15	40	5.5	VAR	20	2.05	1.19	45.25	52.90
	55-10-15	10	15		15	40	5.5	VAR	20	3.39	2.49	48.80	51.70
	85-10-15	10	15		15	50	8.6	VAR	20	4.00	2.88	54.80	57.70
	85-10-15Y	10	15		20	50	8.6	VAR	25	4.20	3.16	63.65	70.40
	85-10-15Z	10	15		25	50	8.6	VAR	30	4.40	3.36	65.40	72.40
	85-12-15X	12	15		15	60	8.6	VAR	20	5.99	4.72	67.60	67.60
	85-12-15Y	12	15		20	60	8.6	VAR	25	6.27	5.00	75.65	83.30
	85-12-15Z	12	15		25	60	8.6	VAR	30	6.56	5.29	77.50	85.65
	85-14-15X	14	15		15	56	8.6	VAR	20	7.93	5.80	134.65	145.25
	85-14-15Z	14	15		25	56	8.6	VAR	30	8.71	6.59	145.35	157.30

This price list does not include the current price increases.  
The short 0.85 mt elements are delivered with a dimension C of 40 cm.

Il presente listino prezzi non tiene conto del supplemento di prezzo.  
Gli elementi da 0,85 mt sono forniti con una dimensione C di 40 cm.

01.01.2022

### Price list / Listino prezzi

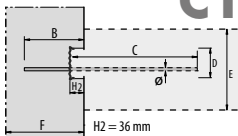
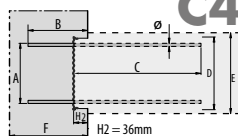
Rebar connections HBT Standard program Armature di ripresa HBT Programma standard	Model Modello	Steel Acciaio Ø MM	Spacing Divisione CM T	Length in CM Lunghezza in CM						Weight ML Peso ML		Price mt Prezzo / mt	
				A	B	C	D	E	F	Sheet and Reinforcement Lamiera e armatura	Reinforcement Armatura	1.25	0.85
 <p><b>C1</b></p>	C1 85-10-15Z	10	15		50	50	8.6	VAR	55	4.99	3.95	72.60	76.60
	C1 85-12-15Z	12	15		60	60	8.6	VAR	65	7.86	6.82	99.70	101.55
	C1 150-14-15Z	14	15		70	70	15	VAR	75	12.40	10.84	227.70	251.30
 <p><b>C4</b></p>	C4 150-10-15Z	10	15	12	50	50	15	18-20	55	9.46	7.90	137.25	152.45
	C4 150-12-15Z	12	15	12	60	60	15	18-20	65	15.20	13.64	196.65	220.25
	C4 150-14-15Z	14	15	12	70	48	15	18-20	75	16.43	14.87	270.25	308.10
	C4 190-10-15Z	10	15	16	50	50	18.6	22	55	9.75	7.90	146.80	164.50
	C4 190-12-15Z	12	15	16	60	60	18.6	22	65	15.49	13.64	223.15	256.65
	C4 190-14-15Z	14	15	16	70	57	18.6	22	75	19.51	17.66	304.75	353.50
	C4 220-10-15Z	10	15	19	50	50	22.2	25	55	10.03	7.90	156.05	177.95
	C4 220-12-15Z	12	15	19	60	60	22.2	25	65	15.77	13.64	216.45	242.55
	C4 220-14-15Z	14	15	19	70	57	22.2	25	75	19.79	17.66	317.40	371.45

La présente liste de prix ne tient pas compte de la hausse de renchérissement en vigueur.  
Les éléments courts à 0.85 mt sont livrés avec une dimension C de 40 cm.

Der Teuerungszuschlag ist in die vorliegende Preisliste nicht enthalten.  
Die 0.85 Mt Element sind mit ein C Mass von 40 cm geliefert.