

Price list / Listino prezzi

Rebar connections AT-cisa
Standard program
Armature di ripresa AT-cisa
Programma standard

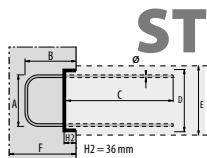

Model Modello	Steel Acciaio Ø MM	Spacing Divisione CM T	Length in CM Lunghezza in CM						Weight ML Peso ML		Price mt Prezzo / mt				
			A	B	C	D	E	F	Sheet and Reinforcement Lamiera e armatura	Reinforcement Armatura	0.60	0.90	1.20	1.80	2.40
S120-10-15	10	15	10	12	*	12.2	15-16	15	7.11	5.50	119.40	114.60	95.50	114.60	119.40
120-10-15	10	15	10	15	*	12.2	15-16	20	7.36	5.75	122.20	117.30	97.70	117.30	122.20
150-10-15	10	15	13	15	*	15	17-20	20	7.72	5.86	132.00	126.80	105.60	126.80	132.00
150-10-15X	10	15	13	15	**	15	17-20	20	8.55	6.68	x	x	131.95	158.40	165.00
150-10-15Y	10	15	13	20	*	15	17-20	25	8.13	6.27	136.90	131.40	109.50	131.40	136.90
150-10-15Z	10	15	13	25	*	15	17-20	30	8.55	6.68	141.80	136.10	113.40	136.10	141.80
150-12-15X	12	15	13	15	*	15	17-20	20	11.48	9.62	176.20	169.10	140.90	169.10	176.20
150-12-15Y	12	15	13	20	*	15	17-20	25	12.07	10.21	183.20	175.80	146.50	175.80	183.20
150-12-15Z	12	15	13	25	*	15	17-20	30	12.67	10.80	190.00	182.40	152.00	182.40	190.00
190-10-15	10	15	17	15	*	18.6	21-25	20	8.18	6.01	143.50	137.80	114.80	137.80	143.50
190-10-15X	10	15	17	15	**	18.6	21-25	20	9.00	6.83	x	x	141.00	169.20	176.30
190-10-15Y	10	15	17	20	*	18.6	21-25	25	8.59	6.42	148.40	142.50	118.70	142.50	148.40
190-10-15Z	10	15	17	25	*	18.6	21-25	30	9.00	6.83	153.30	147.20	122.60	147.20	153.30
190-12-15X	12	15	17	15	*	18.6	21-25	20	12.00	9.83	188.50	181.00	150.80	181.00	188.50
190-12-15Y	12	15	17	20	*	18.6	21-25	25	12.59	10.43	195.50	187.70	156.40	187.70	195.50
190-12-15Z	12	15	17	25	*	18.6	21-25	30	13.18	11.02	202.50	194.40	162.00	194.40	202.50
190-14-15X	14	15	17	15	*	18.6	21-25	20	16.53	14.37	302.90	290.80	242.30	290.80	302.90
190-14-15Z	14	15	17	25	*	18.6	21-25	30	18.15	15.98	330.00	316.80	264.00	316.80	330.00
190-14-15Z3	14	15	17	30	*	18.6	21-25	35	18.95	16.79	343.60	329.90	274.85	329.90	343.60

This price list does not include the current price increases. Il presente listino prezzi non tiene conto del supplemento di prezzo.

* Dimension C / Dimensione C: (cm)

	Length of the pieces (ML) / Lunghezza dei pezzi (ML)		
	0.60	0.90	1.20 / 1.80 / 2.40
Ø10	36	50	50
Type X / Tipo X Ø10			60
Ø12	36	50	60
Ø14	36	50	66

01.11.2018

Price list / Listino prezzi

Rebar connections AT-cisa
Standard program
Armature di ripresa AT-cisa
Programma standard

Model Modello	Steel Acciaio Ø MM	Spacing Divisione CM T	Length in CM Lunghezza in CM						Weight ML Peso ML		Price mt Prezzo / mt				
			A	B	C	D	E	F	Sheet and Reinforcement Lamiera e armatura	Reinforcement Armatura	0.60	0.90	1.20	1.80	2.40
240-10-15	10	15	22	15	*	24	≥26	20	8.86	6.23	162.80	156.30	130.20	156.30	162.80
240-10-15X	10	15	22	15	**	24	≥26	20	9.69	7.05	x	x	154.40	185.30	193.00
240-10-15Y	10	15	22	20	*	24	≥26	25	9.28	6.64	167.50	160.80	134.00	160.80	167.50
240-10-15Z	10	15	22	25	*	24	≥26	30	9.69	7.05	172.40	165.50	137.90	165.50	172.40
240-12-15X	12	15	22	15	*	24	≥26	20	12.79	10.15	208.80	200.40	167.00	200.40	208.80
240-12-15Y	12	15	22	20	*	24	≥26	25	13.38	10.74	215.80	207.20	172.60	207.20	215.80
240-12-15Z	12	15	22	25	*	24	≥26	30	13.97	11.34	222.70	213.80	178.10	213.80	222.70
240-14-15X	14	15	22	15	*	24	≥26	20	17.44	14.80	323.40	310.40	258.65	323.40	336.30
240-14-15Z	14	15	22	25	*	24	≥26	30	19.05	16.42	350.50	336.50	280.35	350.50	364.50
240-14-15Z3	14	15	22	30	*	24	≥26	35	19.86	17.22	364.00	349.50	291.20	364.00	378.60
240-14-15Z4	14	15	22	40	*	24	≥26	45	21.47	18.84	391.20	375.50	312.90	391.20	406.80

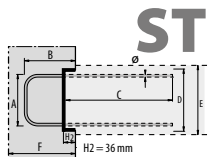

From typ 280, box with 12 cm / Dal modello 280, piastre a 12 cm

280-14-15X	14	15	24	15	*	28	≥29	20	18.23	15.00	343.50	329.80	274.80	384.80	398.50
280-14-15Z	14	15	24	25	*	28	≥29	30	19.85	16.62	370.70	355.80	296.50	415.10	430.00
280-14-15Z3	14	15	24	30	*	28	≥29	35	20.65	17.42	384.20	368.90	307.35	430.30	445.70
280-14-15Z4	14	15	24	40	*	28	≥29	45	22.27	19.04	411.40	394.90	329.05	460.70	477.20
380-14-15X	14	15	34	15	*	38	≥39	20	19.04	15.81	357.10	342.80	285.65	400.00	414.20
380-14-15Z	14	15	34	25	*	38	≥39	30	20.65	17.42	384.20	368.90	307.35	430.30	445.70
380-14-15Z3	14	15	34	30	*	38	≥39	35	21.46	18.23	397.80	381.90	318.20	445.50	461.40
380-14-15Z4	14	15	34	40	*	38	≥39	45	23.07	19.84	424.80	407.80	339.80	475.80	492.80
480-14-15X	14	15	44	15	*	48	≥49	20	19.85	16.62	370.70	355.80	296.50	415.10	430.00
480-14-15Z	14	15	44	25	*	48	≥49	30	21.46	18.23	397.80	381.90	318.20	445.50	461.40
480-14-15Z3	14	15	44	30	*	48	≥49	35	22.27	19.04	411.40	394.90	329.05	460.70	477.20
480-14-15Z4	14	15	44	40	*	48	≥49	45	28.72	25.49	438.50	420.90	350.75	491.10	508.60

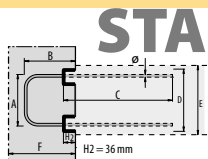

This price list does not include the current price increases. Il presente listino prezzi non tiene conto del supplemento di prezzo.

* Dimension C / Dimensione C: (cm)

	Length of the pieces (ML) / Lunghezza dei pezzi (ML)		
	0.60	0.90	1.20 / 1.80 / 2.40
Ø10	36	50	50
Type X / Tipo X Ø10			60
Ø12	36	50	60
Ø14	36	50	66

Price list / Listino prezzi

Rebar connections AT-cisa
Standard program
Armature di ripresa AT-cisa
Programma standard

Model Modello	Steel Acciaio Ø MM	Spacing Divisione CM T	Length in CM Lunghezza in CM							Weight ML Peso ML		Price mt Prezzo / mt				
			A	B	C	D	E	F	Sheet and Reinforcement Lamiera e armatura	Reinforcement Armatura	0.60	0.90	1.20	1.80	2.40	
K																
K150-10-15	10	15	13	15	14	15	17-20	20	5.79	3.93	149.80	143.80	119.80	143.80	149.80	
K150-12-15X	12	15	13	15	14	15	17-20	20	7.52	5.65	170.40	163.60	136.30	163.60	170.40	
K150-12-15Y	12	15	13	20	14	15	17-20	25	8.11	6.25	177.50	170.40	142.00	170.40	177.50	
K150-12-15Z	12	15	13	25	18	15	17-20	30	9.17	7.31	184.70	177.30	147.70	177.30	184.70	
K190-12-15X	12	15	17	15	14	19	21-25	20	8.46	6.29	221.90	213.00	177.50	213.00	221.90	
K190-12-15Y	12	15	17	20	14	19	21-25	25	9.05	6.88	229.00	219.90	183.20	219.90	229.00	
K190-12-15Z	12	15	17	25	18	19	21-25	30	10.12	7.95	282.30	271.00	225.80	271.00	282.30	
K2																
K2150-12-15X	12	15	13	15	18	15	17-20	20	10.65	8.79	276.70	265.60	221.30	265.60	276.70	
K2150-12-15Y	12	15	13	20	18	15	17-20	25	11.25	9.38	285.30	273.90	228.20	273.90	285.30	
K2150-12-15Z	12	15	13	25	18	15	17-20	30	11.84	9.98	294.00	282.30	235.20	282.30	294.00	
K2190-10-15Y	10	15	17	20	14	19	21-25	25	8.80	6.63	219.80	211.00	175.80	211.00	219.80	
K2190-10-15Z	10	15	17	25	14	19	21-25	30	9.21	7.05	240.20	230.60	192.10	230.60	240.20	
K2190-12-15X	12	15	17	15	14	19	21-25	20	11.12	8.96	286.00	274.60	228.80	274.60	286.00	
K2190-12-15Y	12	15	17	20	18	19	21-25	25	12.19	10.02	294.70	282.90	235.70	282.90	294.70	
K2190-12-15Z	12	15	17	25	22	19	21-25	30	13.25	11.09	336.40	323.00	269.10	323.00	336.40	
K2240-12-15Y	12	15	22	20	22	24	≥26	25	14.00	11.37	366.20	351.50	292.90	351.50	366.20	
K2240-12-15Z	12	15	22	25	22	24	≥26	30	14.59	11.96	375.40	360.40	300.30	360.40	375.40	
C																
C120-10-15	10	15		15	*	12.2	VAR	20	4.70	3.09	97.70	93.80	78.10	93.80	97.70	
C120-10-15X	10	15		15	**	12.2	VAR	20	5.11	3.50	x	x	83.65	100.40	104.60	
C120-10-15Y	10	15		20	*	12.2	VAR	25	4.90	3.29	101.10	97.10	80.85	97.10	101.10	
C120-10-15Z	10	15		25	*	12.2	VAR	30	5.11	3.50	104.60	100.40	83.65	100.40	104.60	
C120-12-15X	12	15		15	*	12.2	VAR	20	6.76	5.15	132.40	127.10	105.90	127.10	132.40	
C120-12-15Y	12	15		20	*	12.2	VAR	25	7.06	5.45	137.40	131.90	109.85	131.90	137.40	
C120-12-15Z	12	15		25	*	12.2	VAR	30	7.36	5.74	142.40	136.70	113.85	136.70	142.40	
C120-14-15X	14	15		15	*	12.2	VAR	20	8.79	7.18	166.50	159.80	133.15	159.80	166.50	
C120-14-15Y	14	15		20	*	12.2	VAR	25	9.20	7.58	173.30	166.40	138.60	166.40	173.30	
C120-14-15Z	14	15		25	*	12.2	VAR	30	9.60	7.99	180.10	172.90	144.05	172.90	180.10	
C120-14-15Z3	14	15		30	*	12.2	VAR	35	10.00	8.39	186.90	179.40	149.45	179.40	186.90	
C120-14-15Z4	14	15		40	*	12.2	VAR	45	10.81	9.20	200.40	192.40	160.30	192.40	200.40	

This price list does not include the current price increases. Il presente listino prezzi non tiene conto del supplemento di prezzo.

* Dimension C / Dimensione C: (cm)

	Length of the pieces (ML) / Lunghezza dei pezzi (ML)		
	0.60	0.90	1.20 / 1.80 / 2.40
Ø10	36	50	50
Type X / Tipo X Ø10			60
Ø12	36	50	60
Ø14	36	50	66