

01.11.2018

| Rebar connections AT-cisa Standard program Armature di ripresa AT-cisa Programma standard | Model Model | Steel Acciaio Ø MM | Spacing Divisione CM T | Length in CM Lunghezza in CM | | | | | | Weight ML Peso ML | |
|--|----------------|--------------------------|---------------------------------|---------------------------------|----|----|------|-----|----|---|---------------------------|
| | | | | A | B | C | D | E | F | Sheet and Reinforcement Lamiera e armatura | Reinforcement Armatura |
| | | | | | | | | | | | |
|  | C120-10-15 | 10 | 15 | | 15 | * | 12.2 | VAR | 20 | 4.70 | 3.09 |
| | C120-10-15X | 10 | 15 | | 15 | ** | 12.2 | VAR | 15 | 5.11 | 3.50 |
| | C120-10-15Y | 10 | 15 | | 20 | * | 12.2 | VAR | 25 | 4.90 | 3.29 |
| | C120-10-15Z | 10 | 15 | | 25 | * | 12.2 | VAR | 30 | 5.11 | 3.50 |
| | C120-12-15X | 12 | 15 | | 15 | * | 12.2 | VAR | 15 | 6.76 | 5.15 |
| | C120-12-15Y | 12 | 15 | | 20 | * | 12.2 | VAR | 25 | 7.06 | 5.45 |
| | C120-12-15Z | 12 | 15 | | 25 | * | 12.2 | VAR | 30 | 7.36 | 5.74 |
| | C120-14-15X | 14 | 15 | | 15 | * | 12.2 | VAR | 15 | 8.79 | 7.18 |
| | C120-14-15Y | 14 | 15 | | 20 | * | 12.2 | VAR | 25 | 9.20 | 7.58 |
| | C120-14-15Z | 14 | 15 | | 25 | * | 12.2 | VAR | 30 | 9.60 | 7.99 |
| | C120-14-15Z3 | 14 | 15 | | 30 | * | 12.2 | VAR | 40 | 10.00 | 8.39 |
| | C120-14-15Z4 | 14 | 15 | | 40 | * | 12.2 | VAR | 50 | 10.81 | 9.20 |

**Single bar
Monobarra**

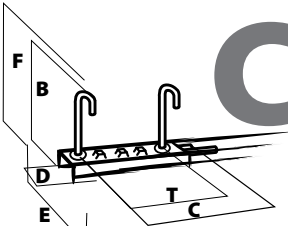
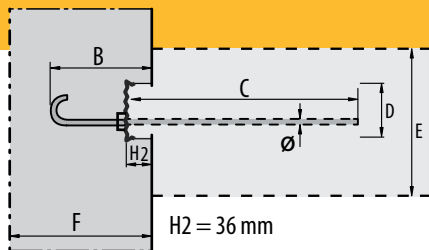

**1st stage
1^a fase**

**2nd stage
2^a fase**

Specially toothed finish for very high demands, which can take up both transverse force perpendicular to the concreting joint and shear force lengthwise to the concreting joint.

Finitura dentata speciale, estremamente robusta, in grado di sostenere il carico trasversale perpendicolare al giunto di ripresa del getto, e il carico di spinta longitudinale al giunto di ripresa del getto.

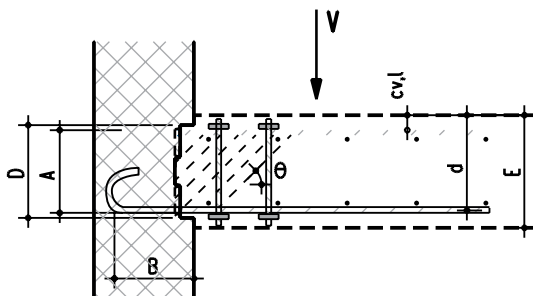

| | Length of the pieces (ML) / Lunghezza dei pezzi (ML) | | | | |
|--|--|------|------|------|------|
| | 0.60 | 0.90 | 1.20 | 1.80 | 2.40 |
| *) Dimension C / Dimensione C Ø10*CM: | 36 | 50 | 50 | 50 | 50 |
| Ø 10 Type X / TipoX ** CM: | | | 60 | 60 | 60 |
| Ø 12 CM: | 36 | 50 | 60 | 60 | 60 |
| Ø 14 CM: Type/Tipo 190 CM: | 36 | 50 | 66 | 66 | 66 |
| Ø 14 CM: Type/Tipo 240 CM: | 36 | 50 | 66 | 66 | 66 |
| Ø 14 CM: Type/Tipo 120/280/380/480 CM: | 36 | 50 | 66 | 66 | 66 |